

Downlight - Emilia Surface (Round) Manual Instruction

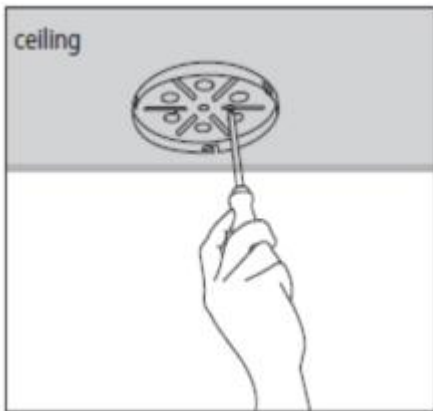

1.) Fix the mounting bracket to the ceiling with 2 screws.

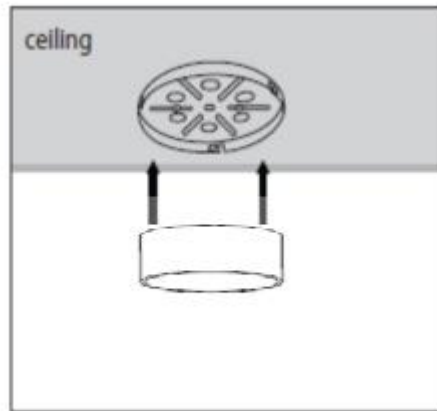

2.) Join the downlight to mounting bracket and fixed with screw

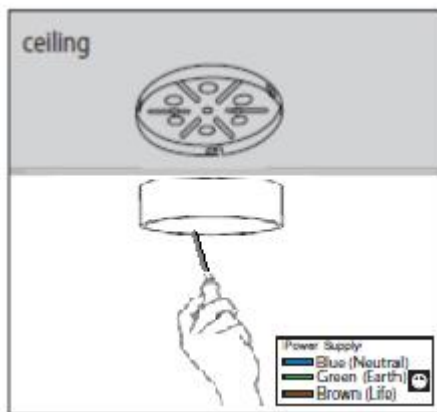

4.) Connect power wire

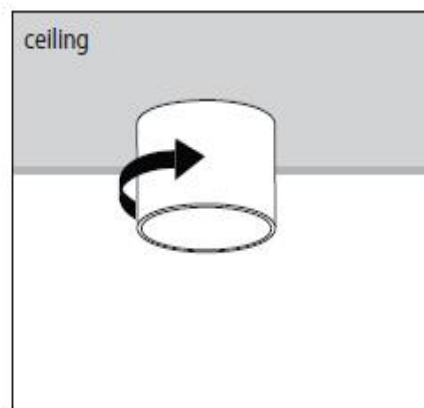

3.) Secured the downlight through rotating / slot in to the bracket.



Note: Specification are subject to change without prior notice



HI-BEAM™ Lighting

